

# Tubelite® TU24000 Storefront

*Dual cavity pour and debridge ultra-thermal barrier*

Tubelite's most popular thermally broken storefront line has been expanded and enhanced with an additional P&D thermal break. The TU24000 Series has the same 2" x 4-1/2" profile as the T14000 system, and offers standard screw-spline or shear block connections.

TU24000 dual cavity pour and debridge ultra-thermal barrier storefront is recommended for use on ground floor storefront or protected low-rise applications. Framing has 3/8" bite for use with glass or panels up to 1" thick. Verticals can be steel-reinforced for high performance against strong windloads. Tubelite 3700 Series operable windows can be glazed into the storefront framing pocket for natural ventilation. Framing is compatible with Tubelite's Medium and Wide Stile Therml=Block® Doors.

Our TU24000 Series Storefront products are subjected to thorough testing by an independent laboratory, ensuring that you get the highest quality storefront framing products that the industry has to offer.

**Therml=Block®**  
HIGH-PERFORMANCE THERMAL FRAMING

**400TU High Performance Thermal Curtainwall**

ALSO USED WITH

**Thermal Entrances**



Wilmington Gardens, Salt Lake City, UT  
Photographer: Cache Valley Photographers

**TUBELITE®**  
**DEPENDABLE**

LEADERS IN ECO-EFFICIENT STOREFRONT, CURTAINWALL AND ENTRANCE SYSTEMS

# Tubelite® TU24000 Storefront

Dual cavity pour and debridge ultra-thermal barrier

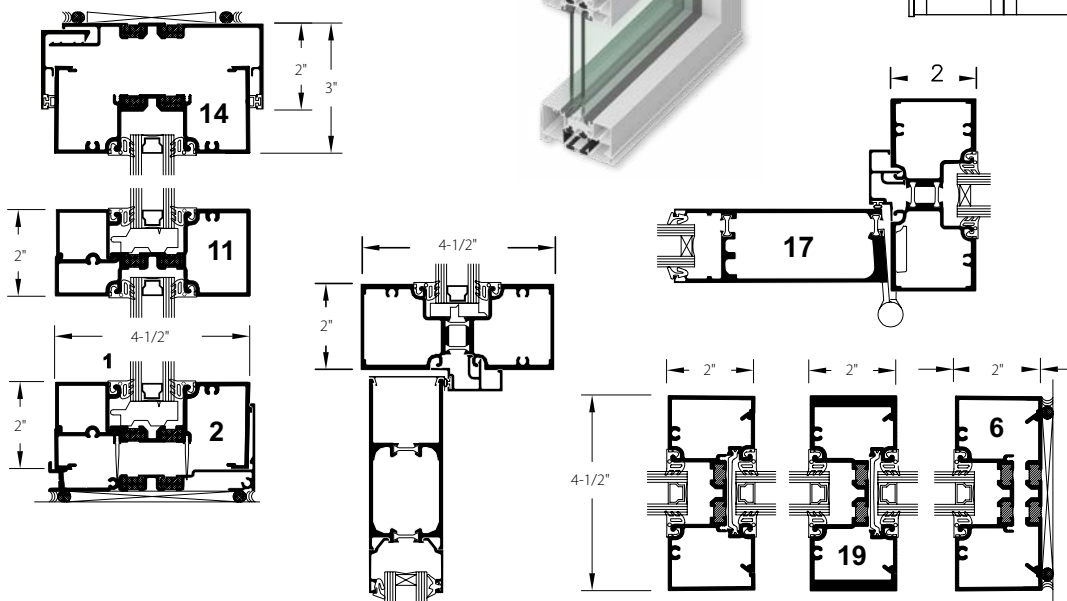
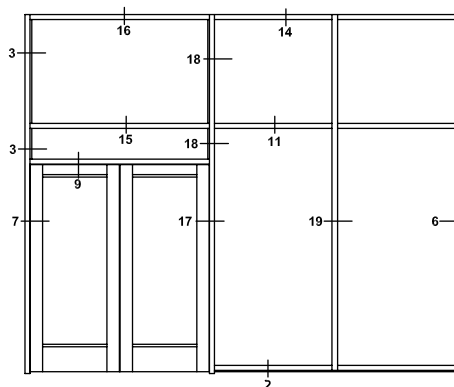
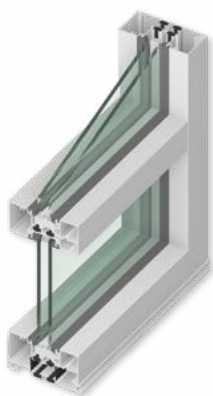

### System Features:

- Standard 2" (50.8mm) sight line on verticals and horizontals
- 4-1/2" (114.3mm) system depth
- Dual cavity pour and debridge ultra-thermal barrier for maximum thermal performance with Azon's Lancer® mechanical lock
- EPDM wedge type gaskets for 1" glass or panel thickness
- Glass centered in the system depth

### Optional Features:

- Screw-spline or shear block connections
- Steel reinforcing if required
- Easily integrates with standard or thermal doors
- A wide variety of standard anodized and painted colors are available to complement any project with warranted protection, as well as street appeal.

### Tubelite® TU24000 Storefront Product Specifications

**Application:** Low and mid-rise commercial buildings requiring high energy and condensation resistance performance

**Description:** 2" x 4-1/2" dual thermal barrier center set storefront system, screw spline or shear block connections, exterior or interior glazed

Face Width:	Overall Depths:	Glass:	Air Infiltration:	Water Infiltration:	Structural:	U-Factor**:	CRF:	Acoustics:
2"	4-1/2"	1" std. (1/8" to 1-1/8")	0.06 CFM / Ft.2 @ 6.24 PSF	12 PSF - Static 12 PSF - Dynamic	30 PSF - Design 45 PSF - Overload	0.31 - Thermally Broken	69 <sub>F</sub> 68 <sub>G</sub>	STC 37 OITC 31

\*\* U-Factor per NFRC 100: COG = 0.24 with warm edge spacer, 2" x 4-1/2" thermal frame.

Refer to the U-Factor table at: [www.tubeliteusa.com/products/storefront/thermlblock-tu24000/](http://www.tubeliteusa.com/products/storefront/thermlblock-tu24000/) for other glass makeups and configurations.

DISCLAIMER: Tubelite takes no responsibility for product selection or application, including, but not limited to, compliance with building codes, safety codes, laws, merchantability or fitness for a particular purpose; and further disclaims all liability for the use, in whole or in part, of this Technical Guide in preparation of project specifications and/or other documents. Technical Guides are subject to change at any time, without notice, and at Tubelite's sole discretion. ©2023 Tubelite

101723

# TUBELITE®

DEPENDABLE

LEADERS IN ECO-EFFICIENT STOREFRONT,  
CURTAINWALL AND ENTRANCE SYSTEMS